



Inglenook House High Street  
Huntingdon, PE28 0LL



Christie Taylor  
Partnered With  
**Simpsons**  
Property Experts

Inglenook House represents a fantastic opportunity to purchase a property that has not been sold in over forty years. The property offers established gardens spanning approximately half an acre and multiple outbuildings which provide a wealth of opportunity for adding additional accommodation to the already generous floorplan of the main residence. The main accommodation comprises an entrance hall leading to a central dining room with open fire, a drawing room, lounge with wood burning stove, a front facing study, utility room, ground floor shower room, a rear hallway and a kitchen/dining room. Upstairs, there is a bathroom, a shower room and four bedrooms which are split across two floors. A charming countryside home with character and potential to improve in a standout village location. Viewing is highly advised.



Asking price £800,000

 4  3  4



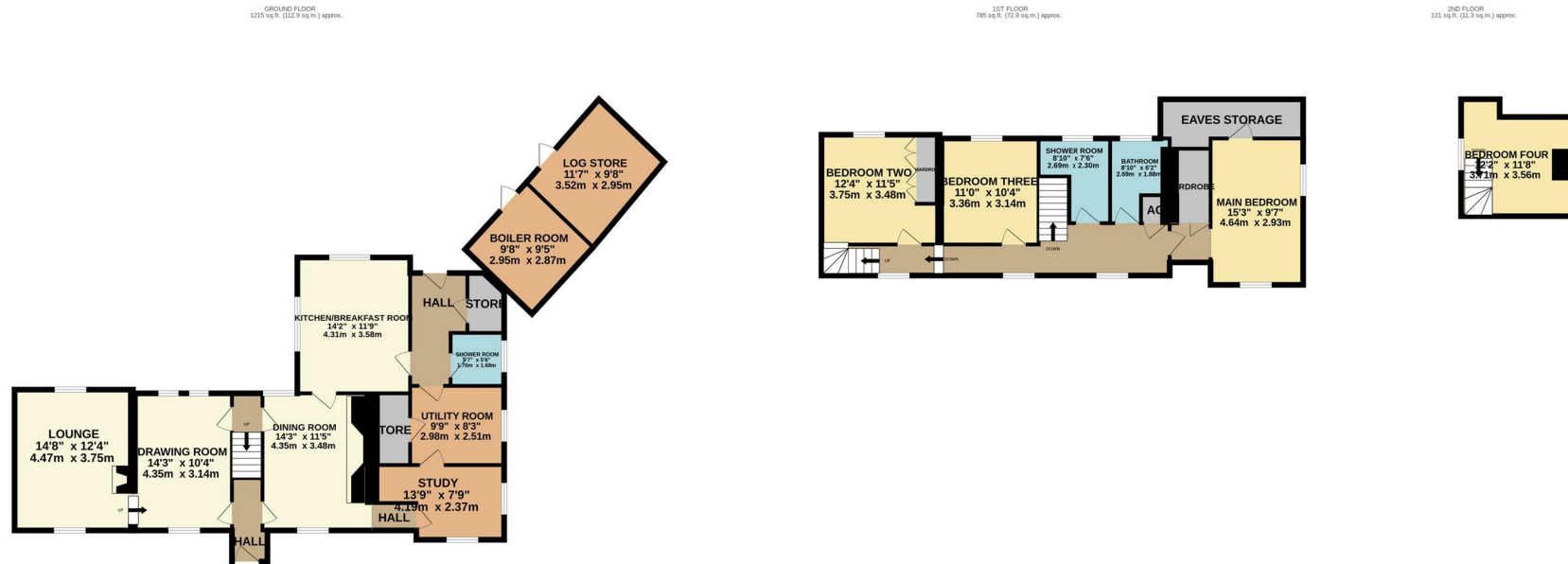

TOTAL FLOOR AREA : 2121 sq.ft. (197.1 sq.m.) approx.

Whilst every attempt has been made to ensure the accuracy of the floor plan contained here, measurements of doors, windows, rooms and any other items are approximate and no responsibility is taken for any error, omission, or mis-statement. The plan is copyright to Simpson and Partners and is for illustrative purposes and should only be used as such by any prospective purchaser. The services, systems and appliances shown have not been tested and no guarantee as to their operability can be given  
Made with Metropix ©2026



### Energy Efficiency Rating

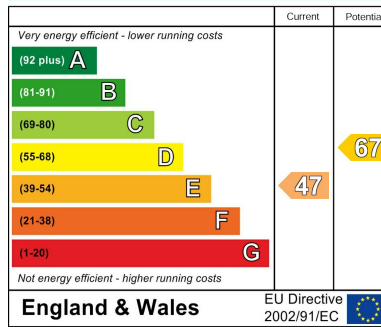

You may download, store and use the material for your own personal use and research. You may not republish, retransmit, redistribute or otherwise make the material available to any party or make the same available on any website, online service or bulletin board of your own or of any other party or make the same available in hard copy or in any other media without the website owner's express prior written consent. The website owner's copyright must remain on all reproductions of material taken from this website.



Christie Taylor  
Partnered With

**Simpsons**  
Property Experts

Tel: 01480 589584

Email: [kimbolton@simpsonspropertyexperts.co.uk](mailto:kimbolton@simpsonspropertyexperts.co.uk)

Web: [simpsonspropertyexperts.co.uk/our-locations/kimbolton](http://simpsonspropertyexperts.co.uk/our-locations/kimbolton)

